



Torque Limiter Instructions

- The Molded Mat Washer drive system is equipped with a torque to prevent the drive rollers from turning in the event of a jammed mat or foreign object stuck in the machine.
 - This assembly consists of a hub mounted to the drive shaft which contains two friction plates on either side of a sprocket. The sprocket will slip when a certain resistance is met, allowing the drive shaft to continue spinning without turning the chain or drive rollers.
 - This component is necessary to prevent damage to the machine as well as prevent personal injury to the user.
 - **Failure to properly set the resistance of the friction plate may result in personal injury as well as damage to the drive system, frame, or other components.**
- To adjust the Torque Limiter Assembly:
 - ADVANCE ADJUSTING NUT UNTIL FINGER TIGHT
 - MATCH MARK THE ADJUSTING NUT TO THE HUB
 - USING THE MATCH MARK AS REFERENCE, TIGHTEN THE ADJUSTING NUT 1/4 - 5/16 OF A FULL ROTATION TO SET THE TORQUE VALUE
 - CHECK FOR PROPER FUNCTION AS DESCRIBED BELOW
 - BEND TABS TO LOCK ADJUSTMENT COLLAR IN PLACE
- Proper Function of Torque Limiter
 - To test function, begin a cycle by pressing the start button and inserting a mat. Maintain a grip on the mat.
 - Once the mat has moved past the brushes, hold the mat and pull against the direction of travel. The mat should remain in place, and the drive rollers should stop spinning. The brush and drive shaft will continue to spin.
 - Troubleshooting:
 - Error: Rollers stop spinning as soon as the mat is inserted.
 - Resolution: Tension too low, tighten the adjustment nut until the mat will feed when no resistance is applied.
 - Error: Rollers will not stop spinning when operator attempts to hold on to mat.
 - Resolution: Tension too high, loosen the adjustment nut until drive system



Tommy Car Wash Systems | **648 South Point Ridge.** | **Holland, MI 49423** | tommycarwash.com.com

Chemical Spray Instructions

- The Chemical Injector is located inside the right-hand side panel between the solenoid and the chemical spray manifold.
 - For use with BRITE a Burgundy Metering Tip is installed by default.
 - A blue metering tip is included in the spare parts bag for use with alternate chemicals that may require a higher ratio
- The default spray time for the chemical manifold is approximately 5 seconds.
- The solenoid will activate every time the start button is pressed. If the machine is stopped and started repeatedly without finishing a full cycle, the brush may become loaded up with more chemical than under normal operation. To properly test chemical usage, allow the machine to run for the full cycle.
- When used with BRITE, mats should exit the machine with little to no residual suds.
- For heavily soiled mats, it is recommended to run the mats through multiple cycles rather than increasing chemical usage.



Tommy Car Wash Systems | 648 South Point Ridge. | Holland, MI 49423 | tommycarwash.com.com

Motor Keys

- Included in the spare parts are multiple replacement motor shaft keys. These square profile strips of stainless are used to connect the spinning motor hubs to their respective driveshafts.
- The first thing to check if a motor is running but the shaft is not spinning is whether a key is present. A missing key will prevent the shaft from turning.
 - The brush motor utilizes the larger $\frac{1}{4}$ " square key.
 - The drive motor utilizes the smaller $\frac{3}{16}$ " square key.

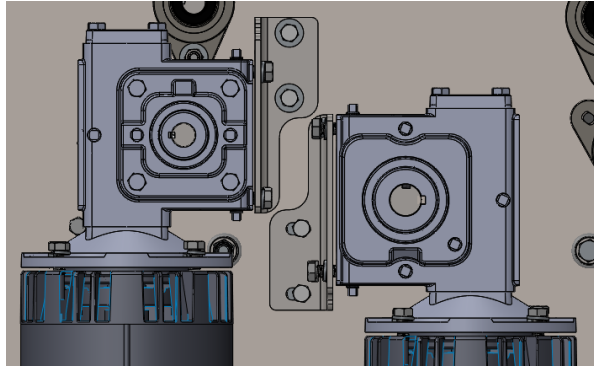

Image [#]

Left: Correct shaft and motor aligned with key installed in keyway.

Right: Motor and shaft out of alignment, key missing.

- The key is retained by a set screw on the inside of the gearbox.

